

COPY

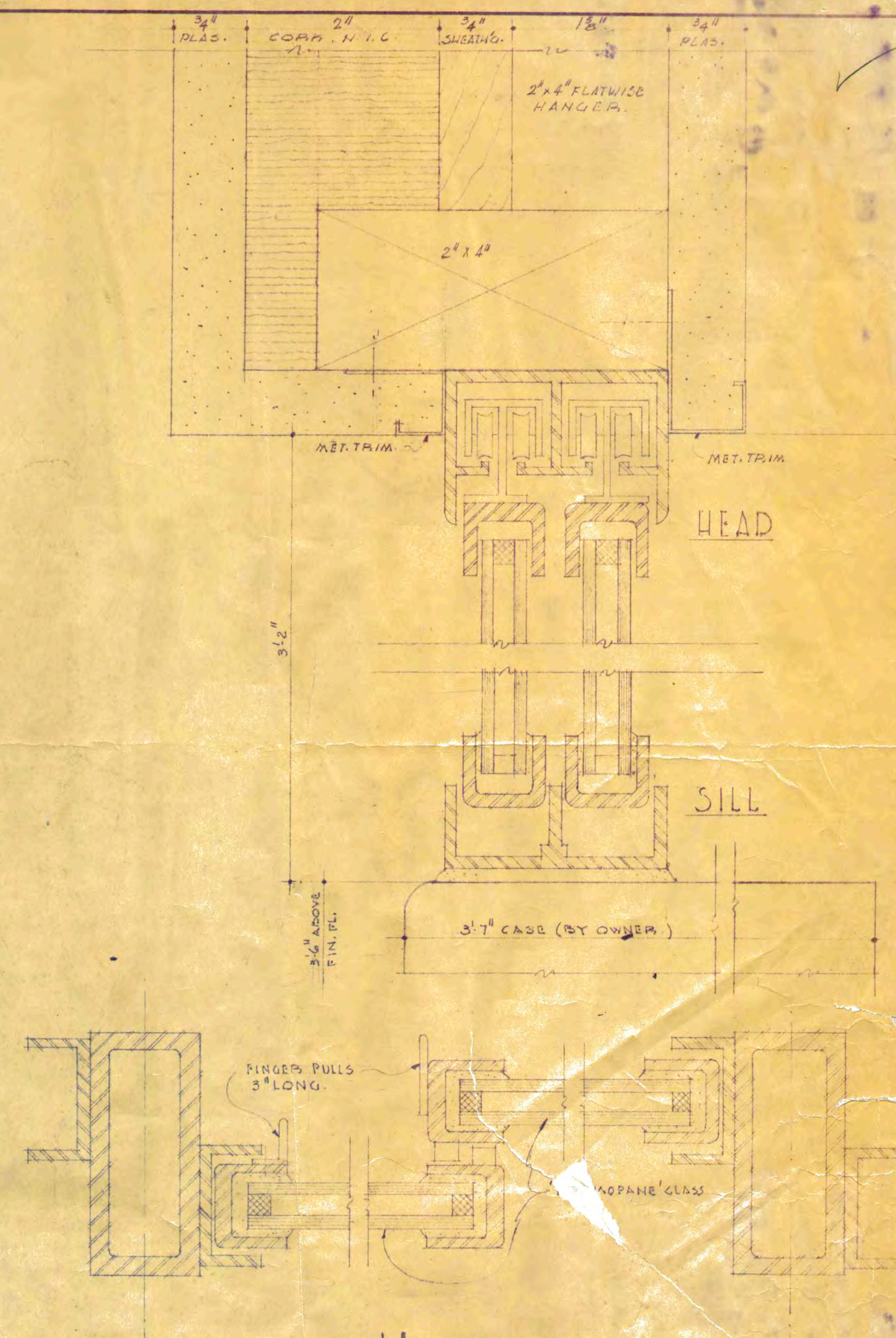
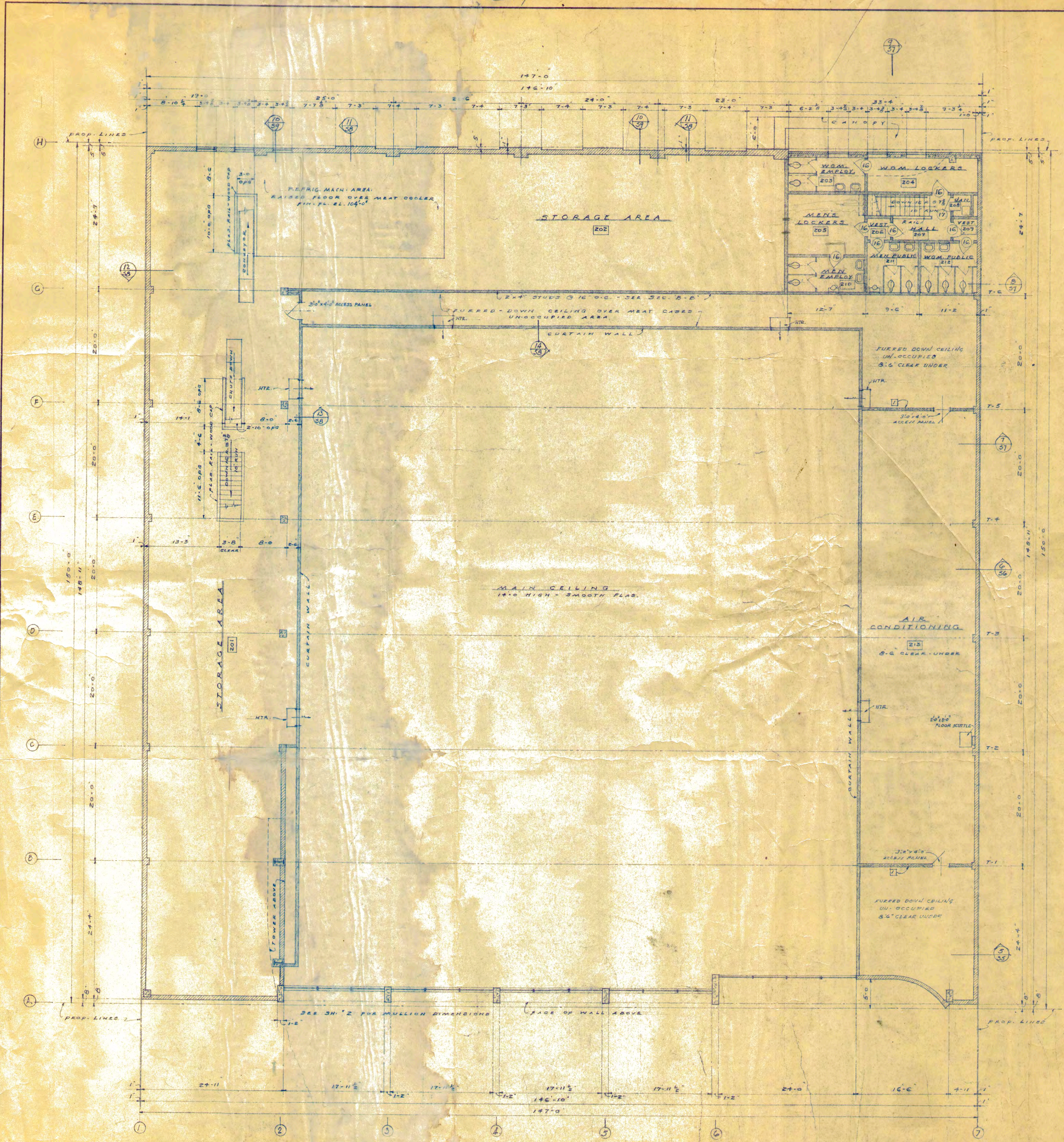

DETAIL SLIDING SASH

SECT. 3

| | | | | | |
|--|--|----------------------------------|---------|--------------------|--|
| DRAWN BY M.I.C.H. | | COMPLETED | 8-11-58 | MEZZANINE FL. PLAN | |
| NO. 1 | | REVISIONS | DATE | 1/2" = 1'-0" | |
| 1 | | MOVE PARTITION TO LOCATION SHOWN | 3-12-50 | | |
| MARKET BUILDING FOR HOUGHIN DEVELOPMENT CORP., LESBON MAYFAIR MARKETS, LESBON BAKERSFIELD, CALIF. | | | | | |
| STILES CLEMENTS ASSOCIATED ARCHITECTS & ENGINEERS 210 W. SEVENTH ST. LOS ANGELES 14, CALIF. | | | | | |